

SILVER SPRINGS PARK

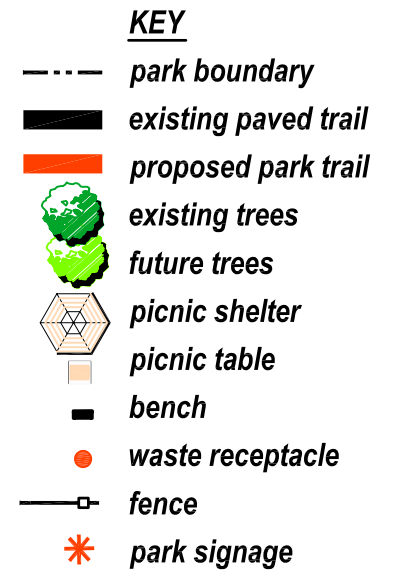
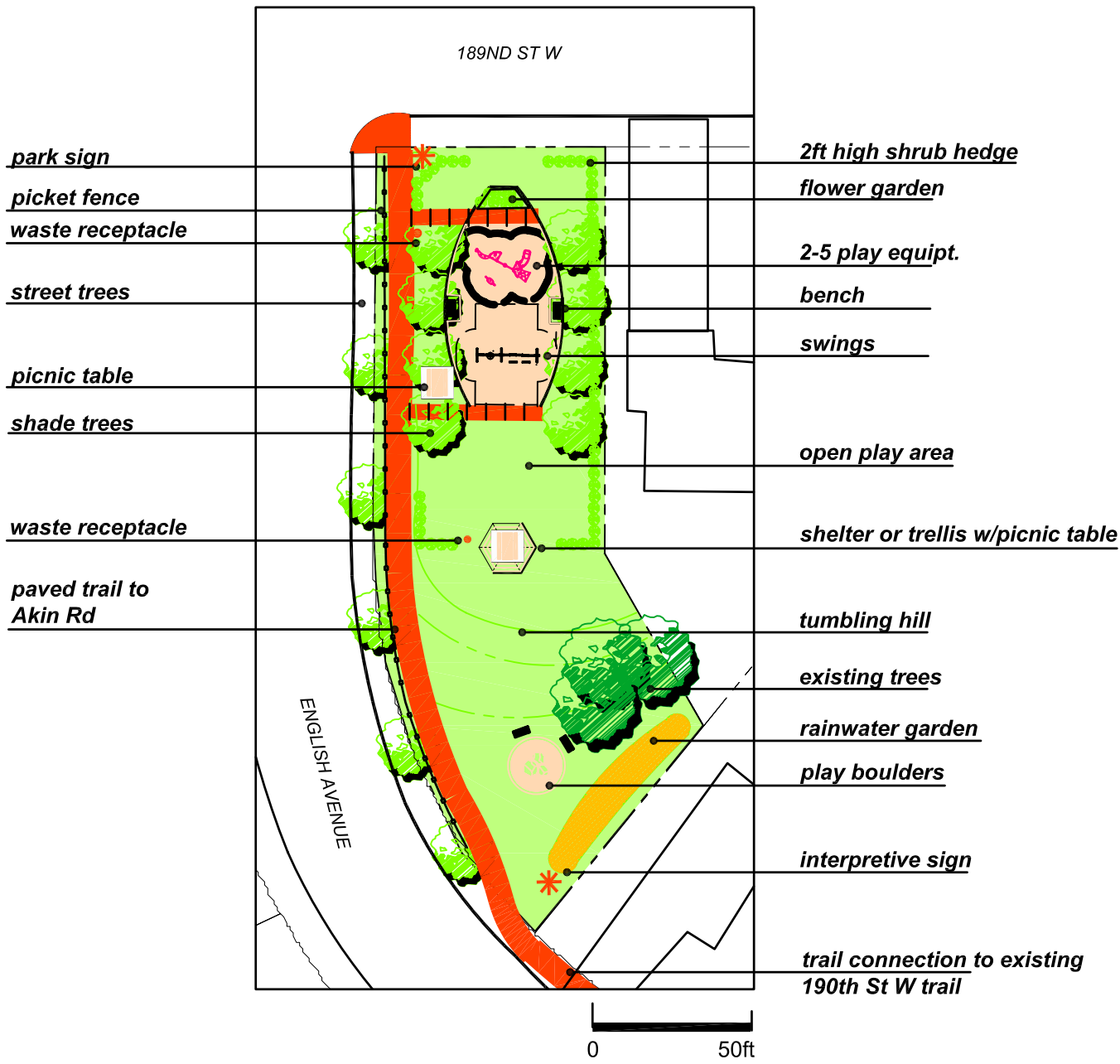

Trail connection to existing 190th St W trail and Pilot Knob Trail

Existing features:

- none

Suggested Future additional features:

- Paved trail from 189th Ave to Akin Road
- Swings
- Play equipment for 2-5 year olds
- Shelter with picnic table
- Metal picket fence along English Avenue
- Street trees along English Avenue
- Shade trees
- Benches
- Waste receptacle
- "Play" boulders
- Rainwater garden with interpretive sign
- Park entry signs
- Shrub hedges 2ft high



example "play" boulder



example metal picket fence



example shelter



example raingarden



example of play equipment for 3-5 year olds



example flower garden

FUTURE POSSIBILITIES

Silver Springs Park - Draft Master Plan Farmington, Minnesota

ADOPTED MARCH 7, 2005

0.7 ACRES

NOTE: THIS MAP IS CONCEPTUAL ONLY AND REPRESENTS ONLY APPROXIMATE LOCATIONS OF PROPERTIES AND FACILITIES.

