

MIDDLE CREEK PARK

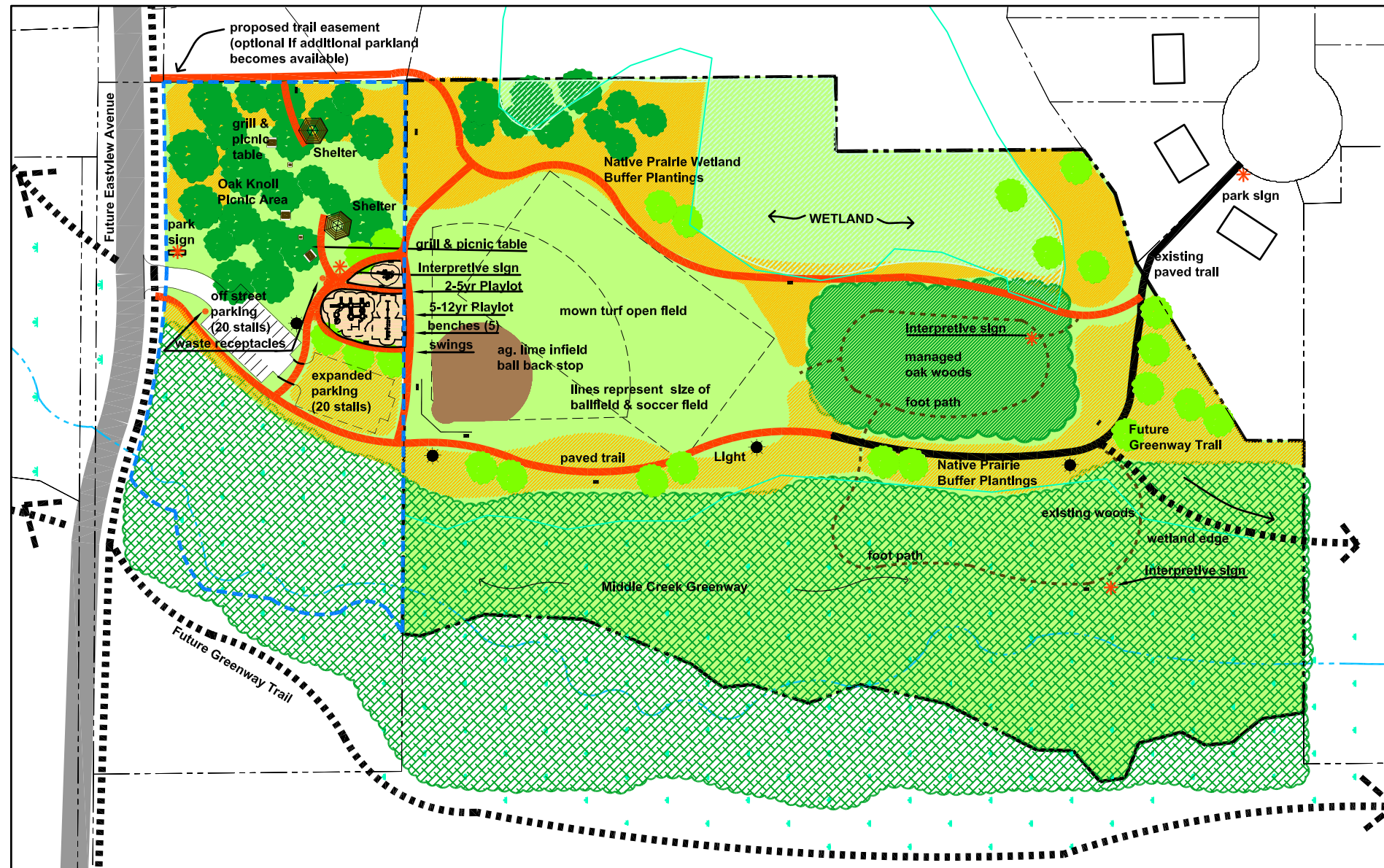

Existing features:

- segment of paved trail
- trail lights(2)
- oak woods

Suggested future additional features:

- Western parcel park acquisition
- Paved trail loop through park
- Trail lights (2)
- Paved trails to picnic and play areas
- 2-5 age play area
- 5-12 age play area
- Swings
- Tree plantings
- Foot trail through woods
- Foot trail through greenway corridor
- Interpretive sign in oak woods, greenway and on oak knoll
- Picnic shelters (2) w/ water and light
- Picnic benches (3) & grills (2)
- Waste receptacles(2)
- Benches at playlots and along trail
- Mown turf field area
- Natural plantings along park edges
- Off street parking (20 stalls)

KEY

park boundary	picnic shelter, table, grill	natural plantings
existing paved trail	bench	mown turf
proposed park trails	waste receptacle	wetland
future city trails	park signage / interpretive	existing trees
trail light		future trees
foot path		
desired additional parkland		



FUTURE POSSIBILITIES

Middle Creek Park- Draft Master Plan

Farmington, Minnesota

ADOPTED MARCH 7, 2005

12 ACRES / 7 ACRES UPLAND
3.3 PROPOSED ADDITIONAL

NOTE: THIS MAP IS CONCEPTUAL ONLY AND REPRESENTS ONLY APPROXIMATE LOCATIONS OF PROPERTIES AND FACILITIES.

